

# CURTI Lift



*administrative office*  
Via Pascolo, 6  
I – 23842 Bosisio Parini

*operative office*  
Triq il-Klamari, 6  
MT – SPB 1513 Qawra

*legal office and production*  
Rruga Tirana Lagja, 14  
AL – 2000 Shkozet Durres



Mob. +39 338 7240150

[luciano@curti.eu](mailto:luciano@curti.eu)

 curtilift



# GENERAL INDEX

1. General Presentation
2. Company Profile
3. Elevators
4. Leonardo Cabin
5. Home Lift
6. Panoramic & Shaft Steel Structure
7. Project & Production
8. Goods Lifts & Platform
9. Escalators
10. Car Parking & Exhibitor

# 1. GENERAL PRESENTATION

CURTI Lift is a company specialising in lift production, as residential and industrial, for private and public vertical transport.

Thanks to forty years of valuable experience and know-how we have been able to realise exceptional achievements. Most recently we produced the ANTISEISMIC LIFT.

The product range includes special, vertical and inclined plants, escalators and moving walkways.

Car Parking Systems, applications of Architectural Design Carpentry, made by steel and glass, complete the production offer.



## 2. COMPANY PROFILE

Our organization has operative branches in Malta, Senegal, Saudi Arabia and Qatar and representative branches in Ukraine and Russia whilst our Head Office is in Romania, our Technical Office is in Italy and Production are in Italy and in Albania.

After 40 years of experience we are now totally re-organizing our structure cater for those markets. Many of the world's leading organisations have already chosen CURTI Lift

Here is a list of some of our references:

- **GIORGIO ARMANI**
- **ARMANI CASA**
- **ERMENEGILDO ZEGNA**
- **BULGARI**
- **ROBERTO CAVALLI Moscow**
- **ROBERTO CAVALLI Milano**
- **BRIONI**
- **TRUSSARDI Paris**
- **FERRARI & MASERATI**
- **FERRARI STORE**
- **DOMODEDOVO AIRPORT Moscow**
- **METRO MM Milan**
- **G8 LA MADDALENA**
- **CAPITAL HILL Moscow**
- **NUOVA SEDE CROCE ROSSA AVIS**
- **PROTEZIONE CIVILE Parabiago**
- **COSMOS DIAMONDS HISTORICAL**
- **HISTORICAL MUSEUM Moscow**
- **HISTORICAL MUSEUM London**
- **IKEA STORE**
- **VATICAN RESIDENCE**
- **RESIDENCE OF THE PRESIDENT**
- **Kazakhstan**
- **RESIDENCE OF PRIME MINISTER OF**
- **Kazakhstan**
- **ITALIAN CONSULATE IN Moscow**
- **SULTANATE of OMAN EMBASSY**
- **Moscow**
- **MINISTERO DELLA MARINA DI RUSSIA**
- **TUAPSE MAR NERO**
- **ASCENSORE ANTISISMICO**

# TUV CERTIFICATION

ZEBERNA® • CLASSE A++ • CERTIFICATO • CERTIFICATO • CERTIFICATO



## ATTESTATO ATTESTATION

**ATTESTATO NO.:** 05.107.107

**Nome ed indirizzo del cliente:** L.R. Europa Srl  
Piazza Parigi, 11  
1205020 Biella (BI) (IT)

**Data della certificazione:** 05.10.2009

**Nome ed indirizzo del fabbricante:** L.R. Europa Srl  
Piazza Parigi, 11  
1205020 Biella (BI) (IT)

**Prodotto e tipo:** Cabina Leonardo, modello 6-6 persone  
Classe A++

**Laboratorio di prova:** TÜV SÜD S.p.A. Via Garibaldi, 725  
120500 - Salto San Giovanni (BI)

**Data e numero rapporto di prova:** 05.10.2009 / 05.107.107

Si attesta che la cabina Leonardo, modello 6-6 persone è conforme ai punti 2.1, 2.2, 2.3, 2.4, 2.5, 2.6, 2.7, 2.8, 2.9, 3.1, 3.2, 3.3, 3.4, 3.5, 3.6, 3.7, 3.8, 3.9, 4.1, 4.2, 4.3, 4.4, 4.5, 4.6, 4.7, 4.8, 4.9, 5.1, 5.2, 5.3, 5.4, 5.5, 5.6, 5.7, 5.8, 5.9, 6.1, 6.2, 6.3, 6.4, 6.5, 6.6, 6.7, 6.8, 6.9, 7.1, 7.2, 7.3, 7.4, 7.5, 7.6, 7.7, 7.8, 7.9, 8.1, 8.2, 8.3, 8.4, 8.5, 8.6, 8.7, 8.8, 8.9, 9.1, 9.2, 9.3, 9.4, 9.5, 9.6, 9.7, 9.8, 9.9, 10.1, 10.2, 10.3, 10.4, 10.5, 10.6, 10.7, 10.8, 10.9, 11.1, 11.2, 11.3, 11.4, 11.5, 11.6, 11.7, 11.8, 11.9, 12.1, 12.2, 12.3, 12.4, 12.5, 12.6, 12.7, 12.8, 12.9, 13.1, 13.2, 13.3, 13.4, 13.5, 13.6, 13.7, 13.8, 13.9, 14.1, 14.2, 14.3, 14.4, 14.5, 14.6, 14.7, 14.8, 14.9, 15.1, 15.2, 15.3, 15.4, 15.5, 15.6, 15.7, 15.8, 15.9, 16.1, 16.2, 16.3, 16.4, 16.5, 16.6, 16.7, 16.8, 16.9, 17.1, 17.2, 17.3, 17.4, 17.5, 17.6, 17.7, 17.8, 17.9, 18.1, 18.2, 18.3, 18.4, 18.5, 18.6, 18.7, 18.8, 18.9, 19.1, 19.2, 19.3, 19.4, 19.5, 19.6, 19.7, 19.8, 19.9, 20.1, 20.2, 20.3, 20.4, 20.5, 20.6, 20.7, 20.8, 20.9, 21.1, 21.2, 21.3, 21.4, 21.5, 21.6, 21.7, 21.8, 21.9, 22.1, 22.2, 22.3, 22.4, 22.5, 22.6, 22.7, 22.8, 22.9, 23.1, 23.2, 23.3, 23.4, 23.5, 23.6, 23.7, 23.8, 23.9, 24.1, 24.2, 24.3, 24.4, 24.5, 24.6, 24.7, 24.8, 24.9, 25.1, 25.2, 25.3, 25.4, 25.5, 25.6, 25.7, 25.8, 25.9, 26.1, 26.2, 26.3, 26.4, 26.5, 26.6, 26.7, 26.8, 26.9, 27.1, 27.2, 27.3, 27.4, 27.5, 27.6, 27.7, 27.8, 27.9, 28.1, 28.2, 28.3, 28.4, 28.5, 28.6, 28.7, 28.8, 28.9, 29.1, 29.2, 29.3, 29.4, 29.5, 29.6, 29.7, 29.8, 29.9, 30.1, 30.2, 30.3, 30.4, 30.5, 30.6, 30.7, 30.8, 30.9, 31.1, 31.2, 31.3, 31.4, 31.5, 31.6, 31.7, 31.8, 31.9, 32.1, 32.2, 32.3, 32.4, 32.5, 32.6, 32.7, 32.8, 32.9, 33.1, 33.2, 33.3, 33.4, 33.5, 33.6, 33.7, 33.8, 33.9, 34.1, 34.2, 34.3, 34.4, 34.5, 34.6, 34.7, 34.8, 34.9, 35.1, 35.2, 35.3, 35.4, 35.5, 35.6, 35.7, 35.8, 35.9, 36.1, 36.2, 36.3, 36.4, 36.5, 36.6, 36.7, 36.8, 36.9, 37.1, 37.2, 37.3, 37.4, 37.5, 37.6, 37.7, 37.8, 37.9, 38.1, 38.2, 38.3, 38.4, 38.5, 38.6, 38.7, 38.8, 38.9, 39.1, 39.2, 39.3, 39.4, 39.5, 39.6, 39.7, 39.8, 39.9, 40.1, 40.2, 40.3, 40.4, 40.5, 40.6, 40.7, 40.8, 40.9, 41.1, 41.2, 41.3, 41.4, 41.5, 41.6, 41.7, 41.8, 41.9, 42.1, 42.2, 42.3, 42.4, 42.5, 42.6, 42.7, 42.8, 42.9, 43.1, 43.2, 43.3, 43.4, 43.5, 43.6, 43.7, 43.8, 43.9, 44.1, 44.2, 44.3, 44.4, 44.5, 44.6, 44.7, 44.8, 44.9, 45.1, 45.2, 45.3, 45.4, 45.5, 45.6, 45.7, 45.8, 45.9, 46.1, 46.2, 46.3, 46.4, 46.5, 46.6, 46.7, 46.8, 46.9, 47.1, 47.2, 47.3, 47.4, 47.5, 47.6, 47.7, 47.8, 47.9, 48.1, 48.2, 48.3, 48.4, 48.5, 48.6, 48.7, 48.8, 48.9, 49.1, 49.2, 49.3, 49.4, 49.5, 49.6, 49.7, 49.8, 49.9, 50.1, 50.2, 50.3, 50.4, 50.5, 50.6, 50.7, 50.8, 50.9, 51.1, 51.2, 51.3, 51.4, 51.5, 51.6, 51.7, 51.8, 51.9, 52.1, 52.2, 52.3, 52.4, 52.5, 52.6, 52.7, 52.8, 52.9, 53.1, 53.2, 53.3, 53.4, 53.5, 53.6, 53.7, 53.8, 53.9, 54.1, 54.2, 54.3, 54.4, 54.5, 54.6, 54.7, 54.8, 54.9, 55.1, 55.2, 55.3, 55.4, 55.5, 55.6, 55.7, 55.8, 55.9, 56.1, 56.2, 56.3, 56.4, 56.5, 56.6, 56.7, 56.8, 56.9, 57.1, 57.2, 57.3, 57.4, 57.5, 57.6, 57.7, 57.8, 57.9, 58.1, 58.2, 58.3, 58.4, 58.5, 58.6, 58.7, 58.8, 58.9, 59.1, 59.2, 59.3, 59.4, 59.5, 59.6, 59.7, 59.8, 59.9, 60.1, 60.2, 60.3, 60.4, 60.5, 60.6, 60.7, 60.8, 60.9, 61.1, 61.2, 61.3, 61.4, 61.5, 61.6, 61.7, 61.8, 61.9, 62.1, 62.2, 62.3, 62.4, 62.5, 62.6, 62.7, 62.8, 62.9, 63.1, 63.2, 63.3, 63.4, 63.5, 63.6, 63.7, 63.8, 63.9, 64.1, 64.2, 64.3, 64.4, 64.5, 64.6, 64.7, 64.8, 64.9, 65.1, 65.2, 65.3, 65.4, 65.5, 65.6, 65.7, 65.8, 65.9, 66.1, 66.2, 66.3, 66.4, 66.5, 66.6, 66.7, 66.8, 66.9, 67.1, 67.2, 67.3, 67.4, 67.5, 67.6, 67.7, 67.8, 67.9, 68.1, 68.2, 68.3, 68.4, 68.5, 68.6, 68.7, 68.8, 68.9, 69.1, 69.2, 69.3, 69.4, 69.5, 69.6, 69.7, 69.8, 69.9, 70.1, 70.2, 70.3, 70.4, 70.5, 70.6, 70.7, 70.8, 70.9, 71.1, 71.2, 71.3, 71.4, 71.5, 71.6, 71.7, 71.8, 71.9, 72.1, 72.2, 72.3, 72.4, 72.5, 72.6, 72.7, 72.8, 72.9, 73.1, 73.2, 73.3, 73.4, 73.5, 73.6, 73.7, 73.8, 73.9, 74.1, 74.2, 74.3, 74.4, 74.5, 74.6, 74.7, 74.8, 74.9, 75.1, 75.2, 75.3, 75.4, 75.5, 75.6, 75.7, 75.8, 75.9, 76.1, 76.2, 76.3, 76.4, 76.5, 76.6, 76.7, 76.8, 76.9, 77.1, 77.2, 77.3, 77.4, 77.5, 77.6, 77.7, 77.8, 77.9, 78.1, 78.2, 78.3, 78.4, 78.5, 78.6, 78.7, 78.8, 78.9, 79.1, 79.2, 79.3, 79.4, 79.5, 79.6, 79.7, 79.8, 79.9, 80.1, 80.2, 80.3, 80.4, 80.5, 80.6, 80.7, 80.8, 80.9, 81.1, 81.2, 81.3, 81.4, 81.5, 81.6, 81.7, 81.8, 81.9, 82.1, 82.2, 82.3, 82.4, 82.5, 82.6, 82.7, 82.8, 82.9, 83.1, 83.2, 83.3, 83.4, 83.5, 83.6, 83.7, 83.8, 83.9, 84.1, 84.2, 84.3, 84.4, 84.5, 84.6, 84.7, 84.8, 84.9, 85.1, 85.2, 85.3, 85.4, 85.5, 85.6, 85.7, 85.8, 85.9, 86.1, 86.2, 86.3, 86.4, 86.5, 86.6, 86.7, 86.8, 86.9, 87.1, 87.2, 87.3, 87.4, 87.5, 87.6, 87.7, 87.8, 87.9, 88.1, 88.2, 88.3, 88.4, 88.5, 88.6, 88.7, 88.8, 88.9, 89.1, 89.2, 89.3, 89.4, 89.5, 89.6, 89.7, 89.8, 89.9, 90.1, 90.2, 90.3, 90.4, 90.5, 90.6, 90.7, 90.8, 90.9, 91.1, 91.2, 91.3, 91.4, 91.5, 91.6, 91.7, 91.8, 91.9, 92.1, 92.2, 92.3, 92.4, 92.5, 92.6, 92.7, 92.8, 92.9, 93.1, 93.2, 93.3, 93.4, 93.5, 93.6, 93.7, 93.8, 93.9, 94.1, 94.2, 94.3, 94.4, 94.5, 94.6, 94.7, 94.8, 94.9, 95.1, 95.2, 95.3, 95.4, 95.5, 95.6, 95.7, 95.8, 95.9, 96.1, 96.2, 96.3, 96.4, 96.5, 96.6, 96.7, 96.8, 96.9, 97.1, 97.2, 97.3, 97.4, 97.5, 97.6, 97.7, 97.8, 97.9, 98.1, 98.2, 98.3, 98.4, 98.5, 98.6, 98.7, 98.8, 98.9, 99.1, 99.2, 99.3, 99.4, 99.5, 99.6, 99.7, 99.8, 99.9, 100.1, 100.2, 100.3, 100.4, 100.5, 100.6, 100.7, 100.8, 100.9, 101.1, 101.2, 101.3, 101.4, 101.5, 101.6, 101.7, 101.8, 101.9, 102.1, 102.2, 102.3, 102.4, 102.5, 102.6, 102.7, 102.8, 102.9, 103.1, 103.2, 103.3, 103.4, 103.5, 103.6, 103.7, 103.8, 103.9, 104.1, 104.2, 104.3, 104.4, 104.5, 104.6, 104.7, 104.8, 104.9, 105.1, 105.2, 105.3, 105.4, 105.5, 105.6, 105.7, 105.8, 105.9, 106.1, 106.2, 106.3, 106.4, 106.5, 106.6, 106.7, 106.8, 106.9, 107.1, 107.2, 107.3, 107.4, 107.5, 107.6, 107.7, 107.8, 107.9, 108.1, 108.2, 108.3, 108.4, 108.5, 108.6, 108.7, 108.8, 108.9, 109.1, 109.2, 109.3, 109.4, 109.5, 109.6, 109.7, 109.8, 109.9, 110.1, 110.2, 110.3, 110.4, 110.5, 110.6, 110.7, 110.8, 110.9, 111.1, 111.2, 111.3, 111.4, 111.5, 111.6, 111.7, 111.8, 111.9, 112.1, 112.2, 112.3, 112.4, 112.5, 112.6, 112.7, 112.8, 112.9, 113.1, 113.2, 113.3, 113.4, 113.5, 113.6, 113.7, 113.8, 113.9, 114.1, 114.2, 114.3, 114.4, 114.5, 114.6, 114.7, 114.8, 114.9, 115.1, 115.2, 115.3, 115.4, 115.5, 115.6, 115.7, 115.8, 115.9, 116.1, 116.2, 116.3, 116.4, 116.5, 116.6, 116.7, 116.8, 116.9, 117.1, 117.2, 117.3, 117.4, 117.5, 117.6, 117.7, 117.8, 117.9, 118.1, 118.2, 118.3, 118.4, 118.5, 118.6, 118.7, 118.8, 118.9, 119.1, 119.2, 119.3, 119.4, 119.5, 119.6, 119.7, 119.8, 119.9, 120.1, 120.2, 120.3, 120.4, 120.5, 120.6, 120.7, 120.8, 120.9, 121.1, 121.2, 121.3, 121.4, 121.5, 121.6, 121.7, 121.8, 121.9, 122.1, 122.2, 122.3, 122.4, 122.5, 122.6, 122.7, 122.8, 122.9, 123.1, 123.2, 123.3, 123.4, 123.5, 123.6, 123.7, 123.8, 123.9, 124.1, 124.2, 124.3, 124.4, 124.5, 124.6, 124.7, 124.8, 124.9, 125.1, 125.2, 125.3, 125.4, 125.5, 125.6, 125.7, 125.8, 125.9, 126.1, 126.2, 126.3, 126.4, 126.5, 126.6, 126.7, 126.8, 126.9, 127.1, 127.2, 127.3, 127.4, 127.5, 127.6, 127.7, 127.8, 127.9, 128.1, 128.2, 128.3, 128.4, 128.5, 128.6, 128.7, 128.8, 128.9, 129.1, 129.2, 129.3, 129.4, 129.5, 129.6, 129.7, 129.8, 129.9, 130.1, 130.2, 130.3, 130.4, 130.5, 130.6, 130.7, 130.8, 130.9, 131.1, 131.2, 131.3, 131.4, 131.5, 131.6, 131.7, 131.8, 131.9, 132.1, 132.2, 132.3, 132.4, 132.5, 132.6, 132.7, 132.8, 132.9, 133.1, 133.2, 133.3, 133.4, 133.5, 133.6, 133.7, 133.8, 133.9, 134.1, 134.2, 134.3, 134.4, 134.5, 134.6, 134.7, 134.8, 134.9, 135.1, 135.2, 135.3, 135.4, 135.5, 135.6, 135.7, 135.8, 135.9, 136.1, 136.2, 136.3, 136.4, 136.5, 136.6, 136.7, 136.8, 136.9, 137.1, 137.2, 137.3, 137.4, 137.5, 137.6, 137.7, 137.8, 137.9, 138.1, 138.2, 138.3, 138.4, 138.5, 138.6, 138.7, 138.8, 138.9, 139.1, 139.2, 139.3, 139.4, 139.5, 139.6, 139.7, 139.8, 139.9, 140.1, 140.2, 140.3, 140.4, 140.5, 140.6, 140.7, 140.8, 140.9, 141.1, 141.2, 141.3, 141.4, 141.5, 141.6, 141.7, 141.8, 141.9, 142.1, 142.2, 142.3, 142.4, 142.5, 142.6, 142.7, 142.8, 142.9, 143.1, 143.2, 143.3, 143.4, 143.5, 143.6, 143.7, 143.8, 143.9, 144.1, 144.2, 144.3, 144.4, 144.5, 144.6, 144.7, 144.8, 144.9, 145.1, 145.2, 145.3, 145.4, 145.5, 145.6, 145.7, 145.8, 145.9, 146.1, 146.2, 146.3, 146.4, 146.5, 146.6, 146.7, 146.8, 146.9, 147.1, 147.2, 147.3, 147.4, 147.5, 147.6, 147.7, 147.8, 147.9, 148.1, 148.2, 148.3, 148.4, 148.5, 148.6, 148.7, 148.8, 148.9, 149.1, 149.2, 149.3, 149.4, 149.5, 149.6, 149.7, 149.8, 149.9, 150.1, 150.2, 150.3, 150.4, 150.5, 150.6, 150.7, 150.8, 150.9, 151.1, 151.2, 151.3, 151.4, 151.5, 151.6, 151.7, 151.8, 151.9, 152.1, 152.2, 152.3, 152.4, 152.5, 152.6, 152.7, 152.8, 152.9, 153.1, 153.2, 153.3, 153.4, 153.5, 153.6, 153.7, 153.8, 153.9, 154.1, 154.2, 154.3, 154.4, 154.5, 154.6, 154.7, 154.8, 154.9, 155.1, 155.2, 155.3, 155.4, 155.5, 155.6, 155.7, 155.8, 155.9, 156.1, 156.2, 156.3, 156.4, 156.5, 156.6, 156.7, 156.8, 156.9, 157.1, 157.2, 157.3, 157.4, 157.5, 157.6, 157.7, 157.8, 157.9, 158.1, 158.2, 158.3, 158.4, 158.5, 158.6, 158.7, 158.8, 158.9, 159.1, 159.2, 159.3, 159.4, 159.5, 159.6, 159.7, 159.8, 159.9, 160.1, 160.2, 160.3, 160.4, 160.5, 160.6, 160.7, 160.8, 160.9, 161.1, 161.2, 161.3, 161.4, 161.5, 161.6, 161.7, 161.8, 161.9, 162.1, 162.2, 162.3, 162.4, 162.5, 162.6, 162.7, 162.8, 162.9, 163.1, 163.2, 163.3, 163.4, 163.5, 163.6, 163.7, 163.8, 163.9, 164.1, 164.2, 164.3, 164.4, 164.5, 164.6, 164.7, 164.8, 164.9, 165.1, 165.2, 165.3, 165.4, 165.5, 165.6, 165.7, 165.8, 165.9, 166.1, 166.2, 166.3, 166.4, 166.5, 166.6, 166.7, 166.8, 166.9, 167.1, 167.2, 167.3, 167.4, 167.5, 167.6, 167.7, 167.8, 167.9, 168.1, 168.2, 168.3, 168.4, 168.5, 168.6, 168.7, 168.8, 168.9, 169.1, 169.2, 169.3, 169.4, 169.5, 169.6, 169.7, 169.8, 169.9, 170.1, 170.2, 170.3, 170.4, 170.5, 170.6, 170.7, 170.8, 170.9, 171.1, 171.2, 171.3, 171.4, 171.5, 171.6, 171.7, 171.8, 171.9, 172.1, 172.2, 172.3, 172.4, 172.5, 172.6, 172.7, 172.8, 172.9, 173.1, 173.2, 173.3, 173.4, 173.5, 173.6, 173.7, 173.8, 173.9, 174.1, 174.2, 174.3, 174.4, 174.5, 174.6, 174.7, 174.8, 174.9, 175.1, 175.2, 175.3, 175.4, 175.5, 175.6, 175.7, 175.8, 175.9, 176.1, 176.2, 176.3, 176.4, 176.5, 176.6, 176.7, 176.8, 176.9, 177.1, 177.2, 177.3, 177.4, 177.5, 177.6, 177.7, 177.8, 177.9, 178.1, 178.2, 178.3, 178.4, 178.5, 178.6, 178.7, 178.8, 178.9, 179.1, 179.2, 179.3, 179.4, 179.5, 179.6, 179.7, 179.8, 179.9, 180.1, 180.2, 180.3, 180.4, 180.5, 180.6, 180.7, 180.8, 180.9, 181.1, 181.2, 181.3, 181.4, 181.5, 181.6, 181.7, 181.8, 181.9, 182.1, 182.2, 182.3, 182.4, 182.5, 182.6, 182.7, 182.8, 182.9, 183.1, 183.2, 183.3, 183.4, 183.5, 183.6, 183.7, 183.8, 183.9, 184.1, 184.2, 184.3, 184.4, 184.5, 184.6, 184.7, 184.8, 184.9, 185.1, 185.2, 185.3, 185.4, 185.5, 185.6, 185.7, 185.8, 185.9, 186.1, 186.2, 186.3, 186.4, 186.5, 186.6, 186.7, 186.8, 186.9, 187.1, 187.2, 187.3, 187.4, 187.5, 187.6, 187.7, 187.8, 187.9, 188.1, 188.2, 188.3, 188.4, 188.5, 188.6, 188.7, 188.8, 188.9, 189.1, 189.2, 189.3, 189.4, 189.5, 189.6, 189.7, 189.8, 189.9, 190.1, 190.2, 190.3, 190.4, 190.5, 190.6, 190.7, 190.8, 190.9, 191.1, 191.2, 191.3, 191.4, 191.5, 191.6, 191.7, 191.8, 191.9, 192.1, 192.2, 192.3, 192.4, 192.5, 192.6, 192.7, 192.8, 192.9, 193.1, 193.2, 193.3, 193.4, 193.5, 193.6, 193.7, 193.8, 193.9, 194.1, 194.2, 194.3, 194.4, 194.5, 194.6, 194.7, 194.8, 194.9, 195.1, 195.2, 195.3, 195.4, 195.5, 195.6, 195.7, 195.8, 195.9, 196.1, 196.2, 196.3, 196.4, 196.5, 196.6, 196.7, 196.8, 196.9, 197.1, 197.2, 197.3, 197.4, 197.5, 197.6, 197.7, 197.8, 197.9, 198.1, 198.2, 198.3, 198.4, 198.5, 198.6, 198.7, 198.8, 198.9, 199.1, 199.2, 199.3, 199.4, 199.5, 199.6, 199.7, 199.8, 199.9, 200.1, 200.2, 200.3, 200.4, 200.5, 200.6, 200.7, 200.8, 200.9, 201.1, 201.2, 201.3, 201.4, 201.5, 201.6, 201.7, 201.8, 201.9, 202.1, 202.2, 202.3, 202.4, 202.5, 202.6, 202.7, 202.8, 202.9, 203.1, 203.2, 203.3, 203.4, 203.5, 203.6, 203.7, 203.8, 203.9, 204.1, 204.2, 204.3, 204.4, 204.5, 204.6, 204.7, 204.8, 204.9, 205.1, 205.2, 205.3, 205.4, 205.5, 205.6, 205.7, 205.8, 205.9

# JOB-SITE



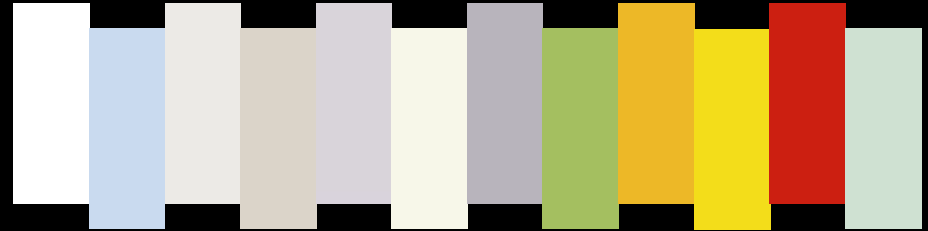

## FLOOR FINITURES



# COP and LOP



### 3. ELEVATORS – Electrical System

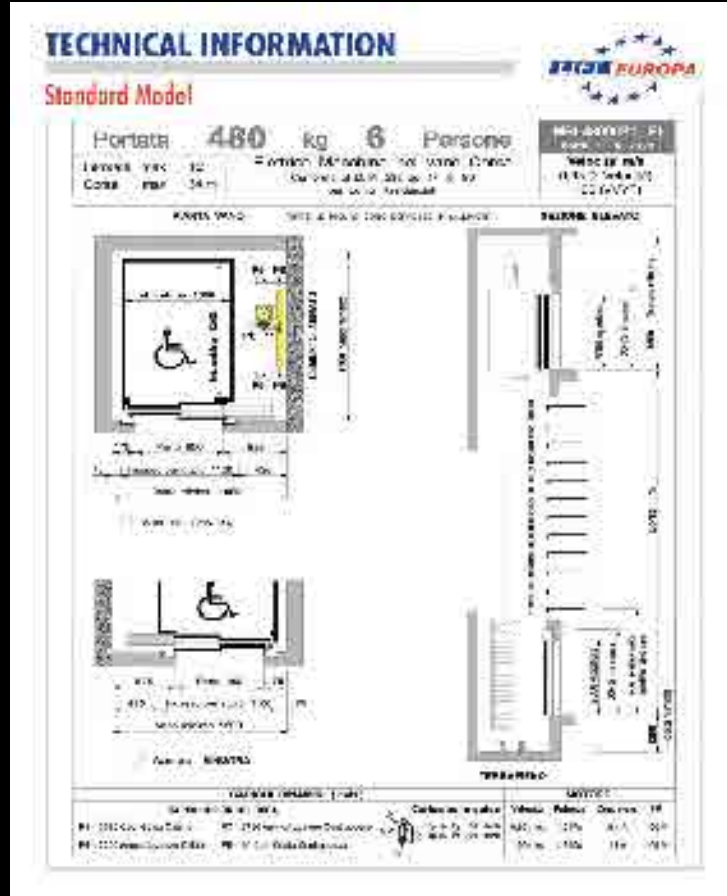

## CABIN COLOURS FINITURES

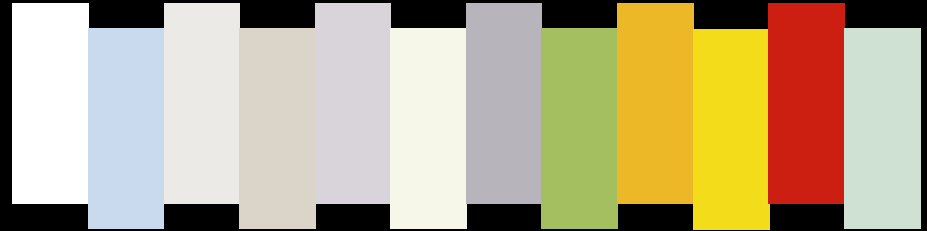

## FLOOR FINITURES



# COP and LOP



# 3. ELEVATORS – SPECIAL CABIN

Monza



### 3. ELEVATORS – SPECIAL CABIN

Palladio



### 3. ELEVATORS – SPECIAL CABIN

Wood



## 4. LEONARDO CABIN - FINISHING



## 4. LEONARDO CABIN – 3D PROJECT



# 4. LEONARDO CABIN – PROJECT

## REVERSIBILITY

The way in which the front of corners are positioned determines the direction in which the door opens.

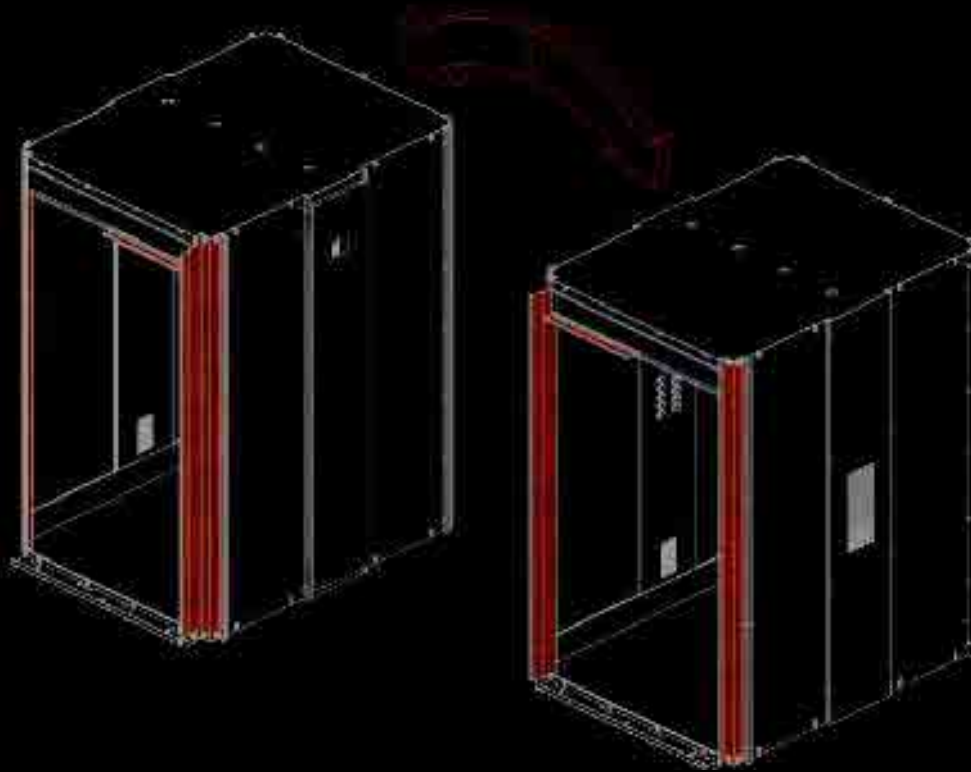

# 4. LEONARDO CABIN – PROJECT

## CUSTOMISATION

Every element of the cabin can be modified. This allows an individual choice of panels, corners and horizontal sections to achieve an aesthetic, personalized and functional result.

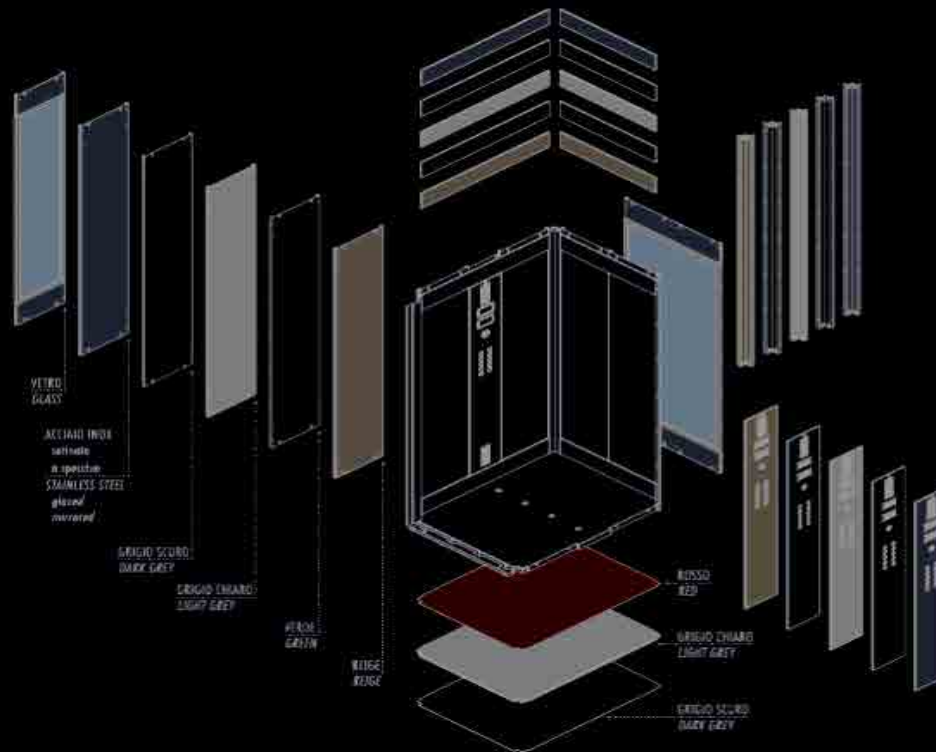

# 4. LEONARDO CABIN – PROJECT

## COP COLUMN

The practicality of creating a column allows rapid repair/replacement interventions.

The weight of the cabin is 220.kg making it ideal as home-lift  
and for low energy consumption lifts



# 4. LEONARDO CABIN – PROJECT



## ROOF AND FLOOR

ROOF and FLOOR are made from the same components for economies of production. They are 50 mm thick, making the cabin ideal for reduced shaft system. LED LIGHTING for low consumption operation that makes the cabin ideal for low energy lifts. DESIGN of the floor cover allows it to vary in thickness up to 20 mm.

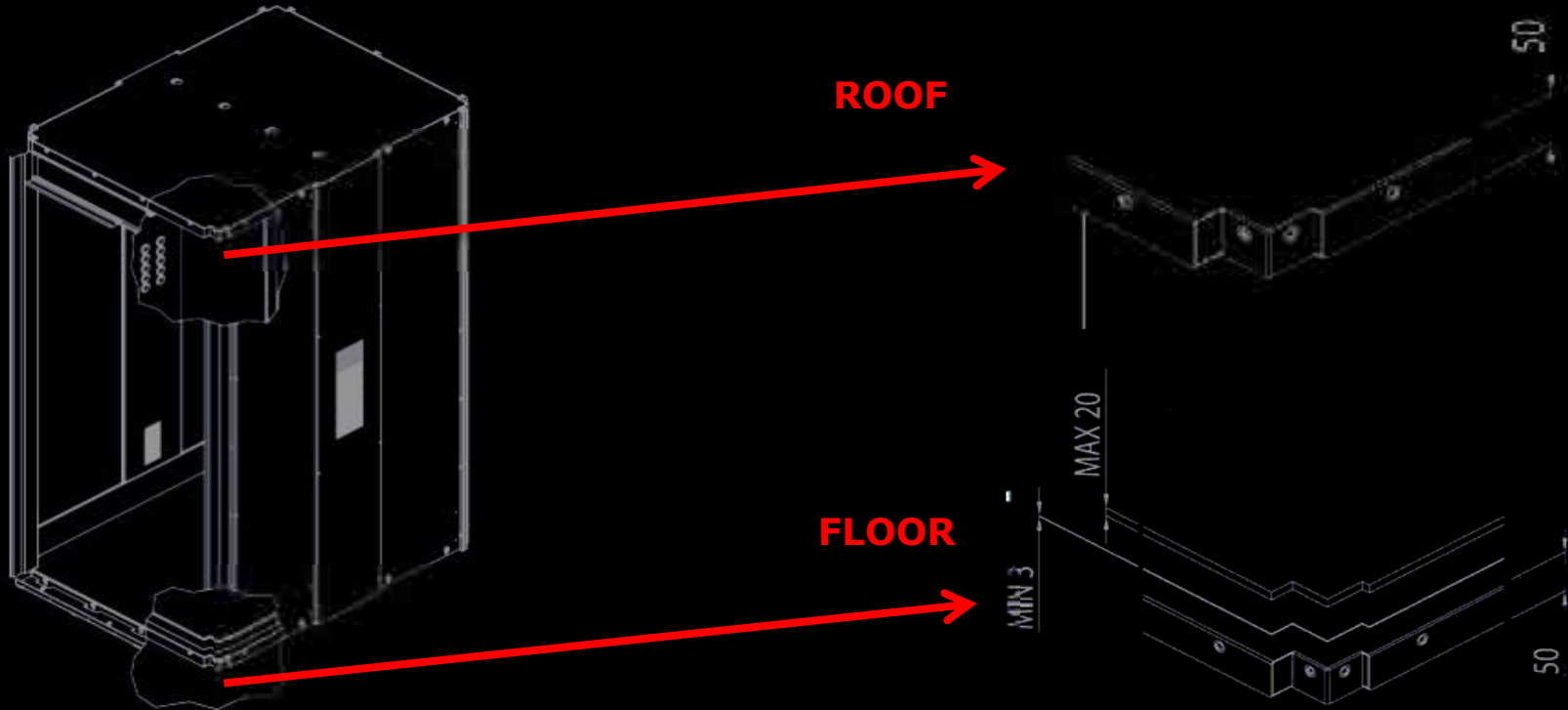

## 5. HOME LIFT - SHOP



## 5. HOME LIFT - DISABLED

**OPEN PLATFORM**



**CLOSED PLATFORM**



## 6. PANORAMIC LIFTS



## 6. PANORAMIC DOORS



# 6. SPECIAL PANORAMIC PROJECT G8 SUMMIT – LA MADDALENA

*Corsa Lift*



# 6. SPECIAL PANORAMIC PROJECT G8 SUMMIT – LA MADDALENA

CORTA Lift

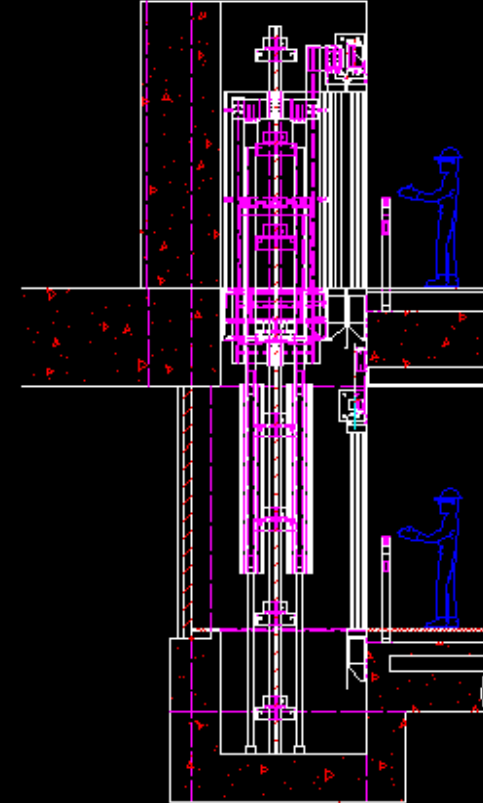
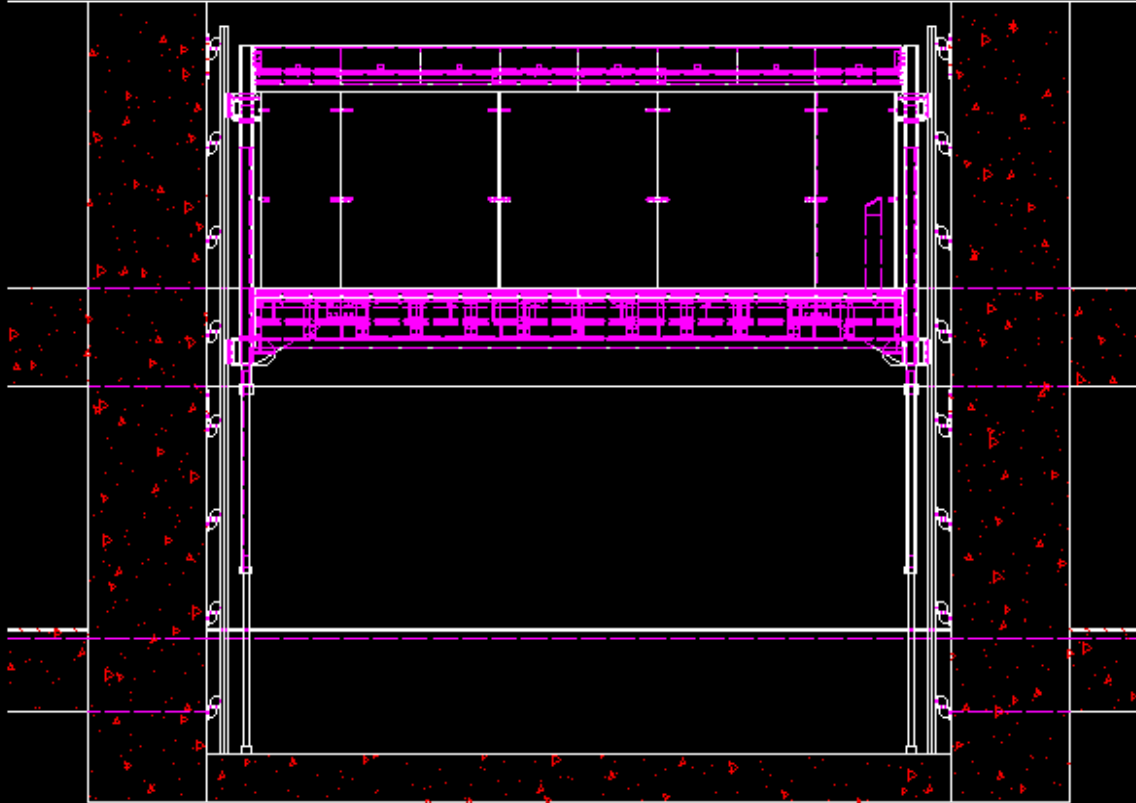

## 6. SPECIAL PANORAMIC PROJECT CAPITAL HILL - MOSCOW

*CURTAIN*

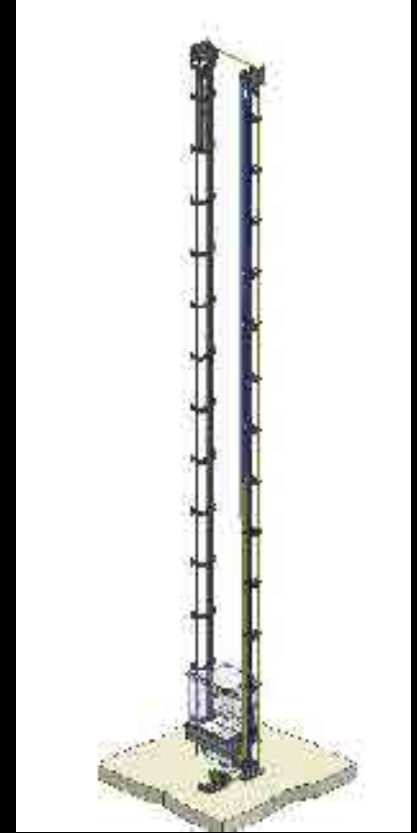
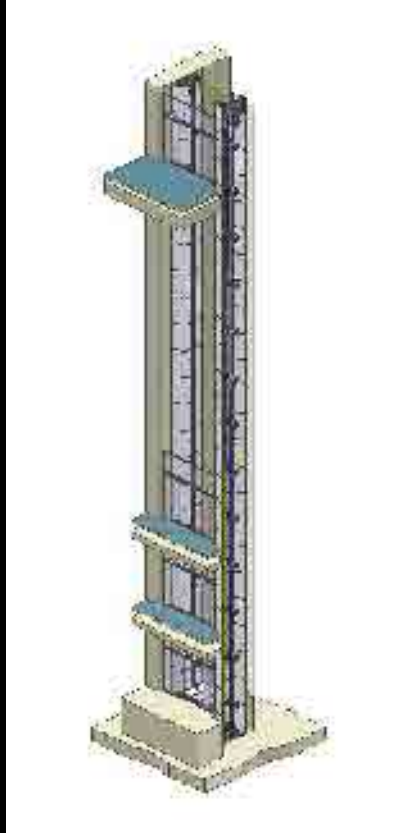

## 6. SPECIAL PANORAMIC PROJECT CAPITAL HILL - MOSCOW

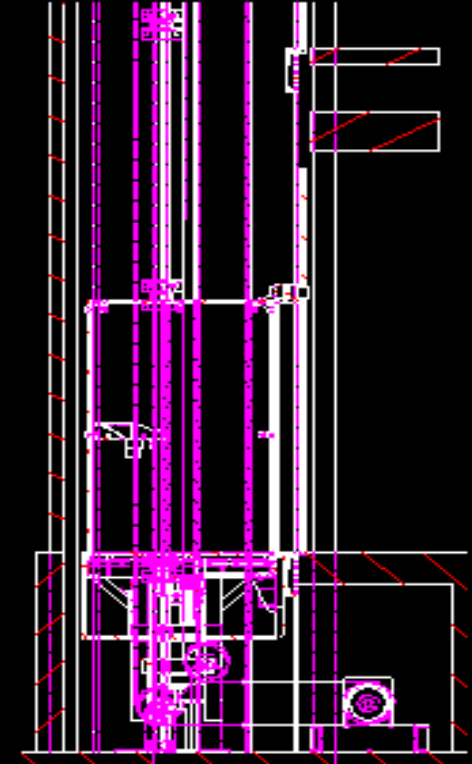
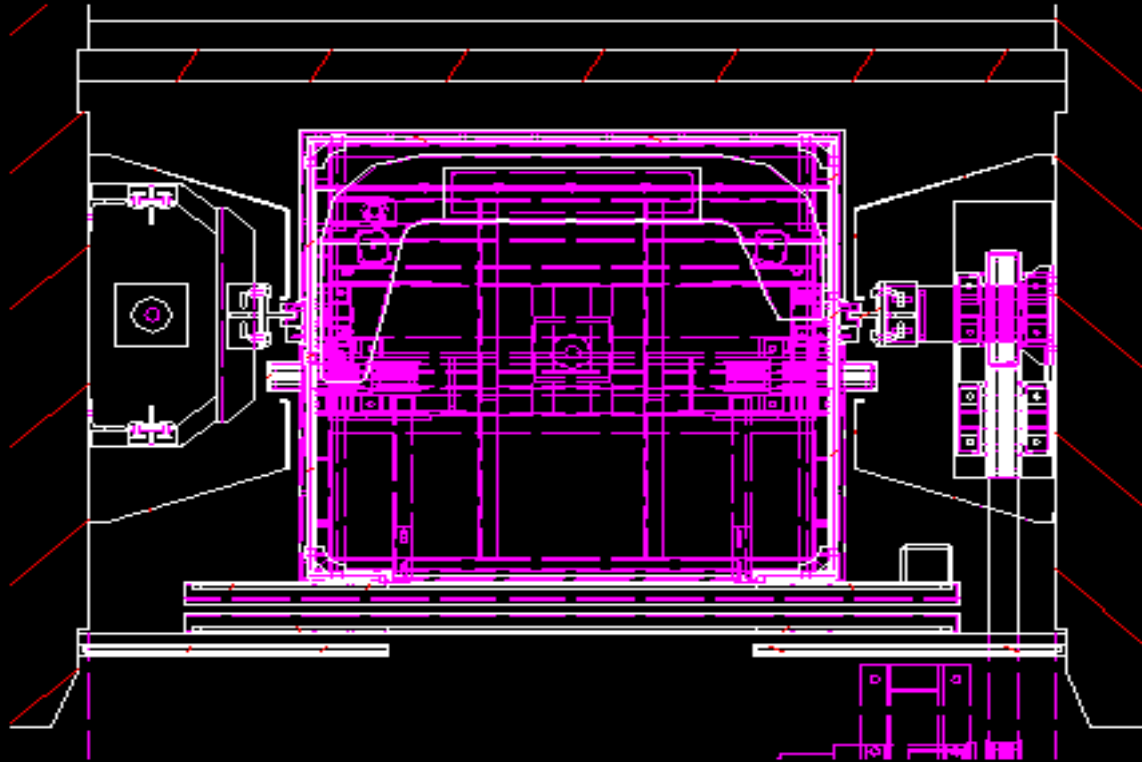

# 6. INCLINED LIFTS



# 6. SHAFT STEEL STRUCTURE



# 7. WAREHOUSES

LIBYA – Tripoli & Benghazi

*Costa Life*



# 7. PROJECT & PRODUCTION

CURA Lift

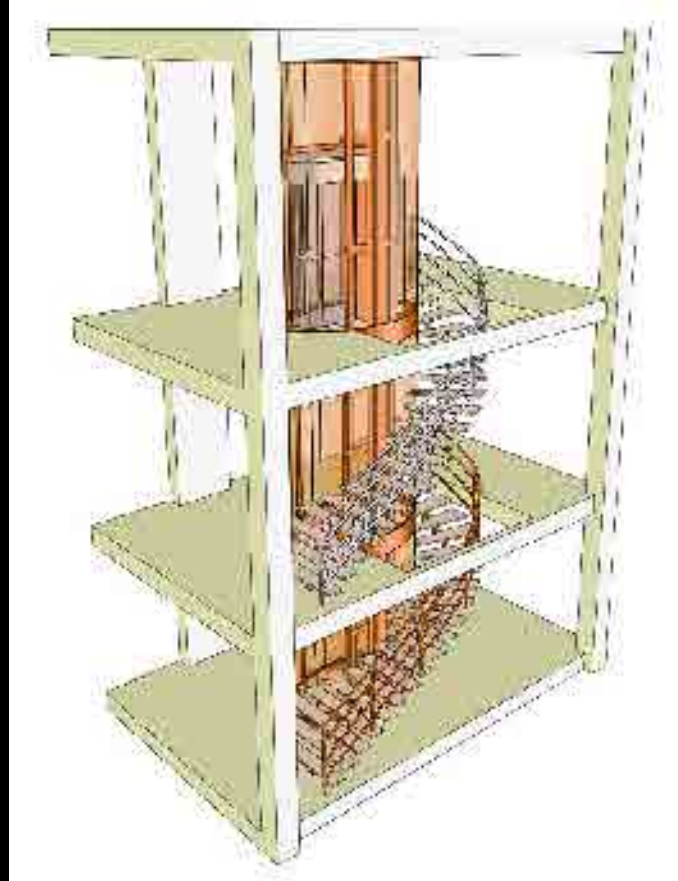

# 7. PROJECT & PRODUCTION



# 7. PROJECT & PRODUCTION



# 7. PROJECT & PRODUCTION



# 7. PROJECT & PRODUCTION

*Curva Lift*



## 8. INDUSTRIAL PLATFORM

*Corsa Lift*



# 8. INDUSTRIAL PLATFORM



# 9. ESCALATORS & WALKWAYS

*CURTIS* Lift



# 9. CAR PARKING



## 9. CAR PARKING



## 9. CAR PARKING



## 9. CAR PARKING



## 9. CAR PARKING



## 9. CAR PARKING



*CURT Lift*